

Code clearance for land traversed by vehicles is 20.1'.
 What the 24' clearance line indicates is not clear

Red = ACCC conductor w/ 1/2" radial ice
 Black = 1272 ACSS conductor @ 392 F = greatest sag
 Red # = structure height with ACCC conductor

If one adds 10' to the attachment point of the ACCC-type conductor, for ground wire, that gives the necessary structure height for ACCC-type conductor.

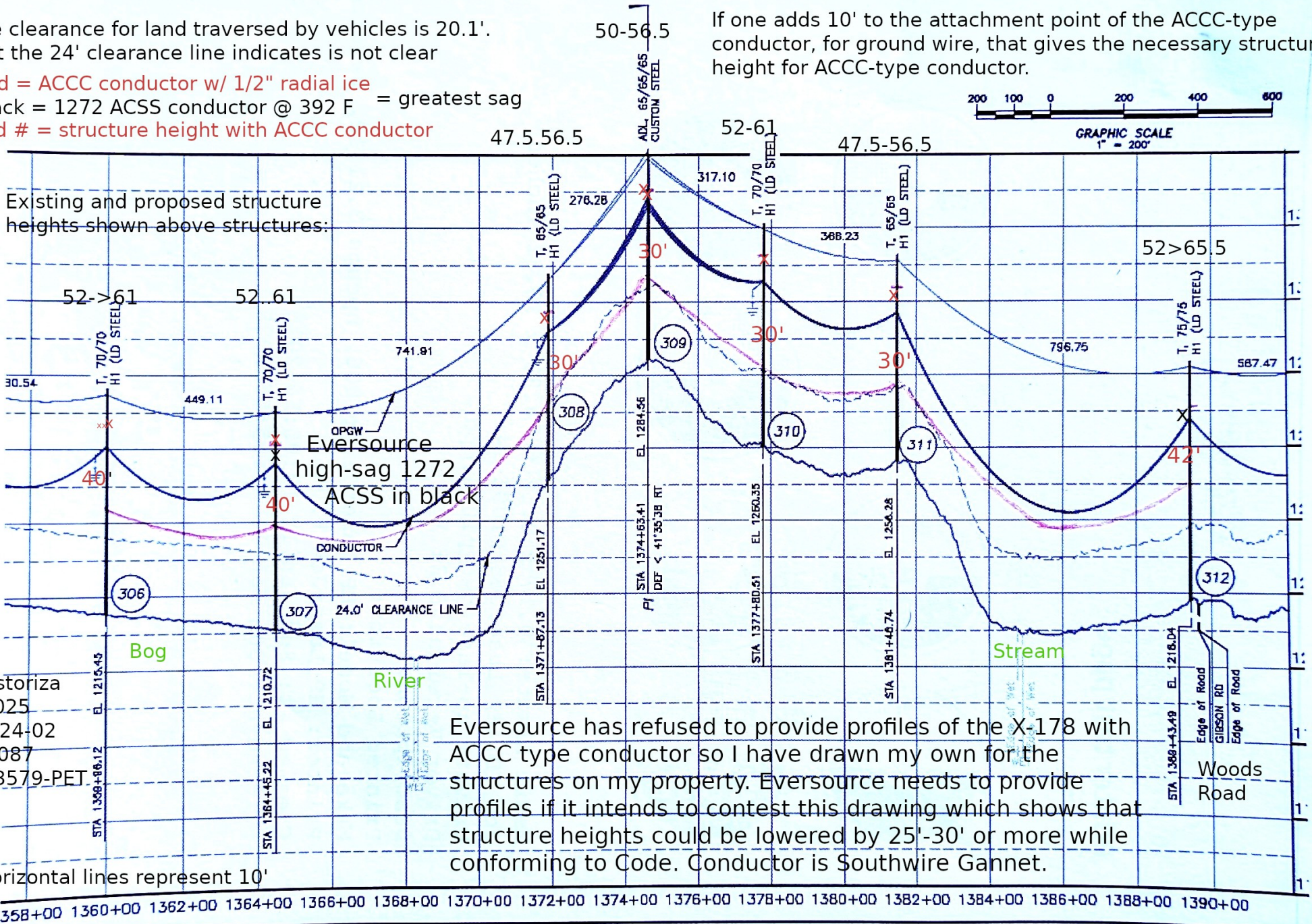

Eversource has refused to provide profiles of the X-178 with ACCC type conductor so I have drawn my own for the structures on my property. Eversource needs to provide profiles if it intends to contest this drawing which shows that structure heights could be lowered by 25'-30' or more while conforming to Code. Conductor is Southwire Gannet.

kris pastoriza
 1/23/2025
 SEC 2024-02
 DE-24-087
 VT 24-3579-PET

Horizontal lines represent 10'

The SEC and PUC need the profiles for ACCC-type conductors of various amperages at minimum clearances.