

LEGEND:

326 LINE: 

326 STR: 

EVERSOURCE ENERGY

326, 345kV LINE
STATE OWNED LAND CROSSING, LOCATION PLAN
LONDONDERRY, NEW HAMPSHIRE
EXHIBIT 1

T	2
DRAWN GBS	
ENGINEER CJN	
CHECKED CJN	
APPROVED CJN	
DATE 03/05/21	

DWG REV	EPN/DESCRIPTION	CONT/PE	DATE	DRN	CHKD	APPR
2	RESUBMITTED TO STATE PUC		03/17/21	GBS	CJN	CJN
1	SUBMITTED TO STATE PUC		03/15/21	GBS	CJN	CJN

SCALE 1" = 1500'	FILE: 032643501.DWG IMAGE:	DRAWING NO. 032643501
---------------------	-------------------------------	--------------------------

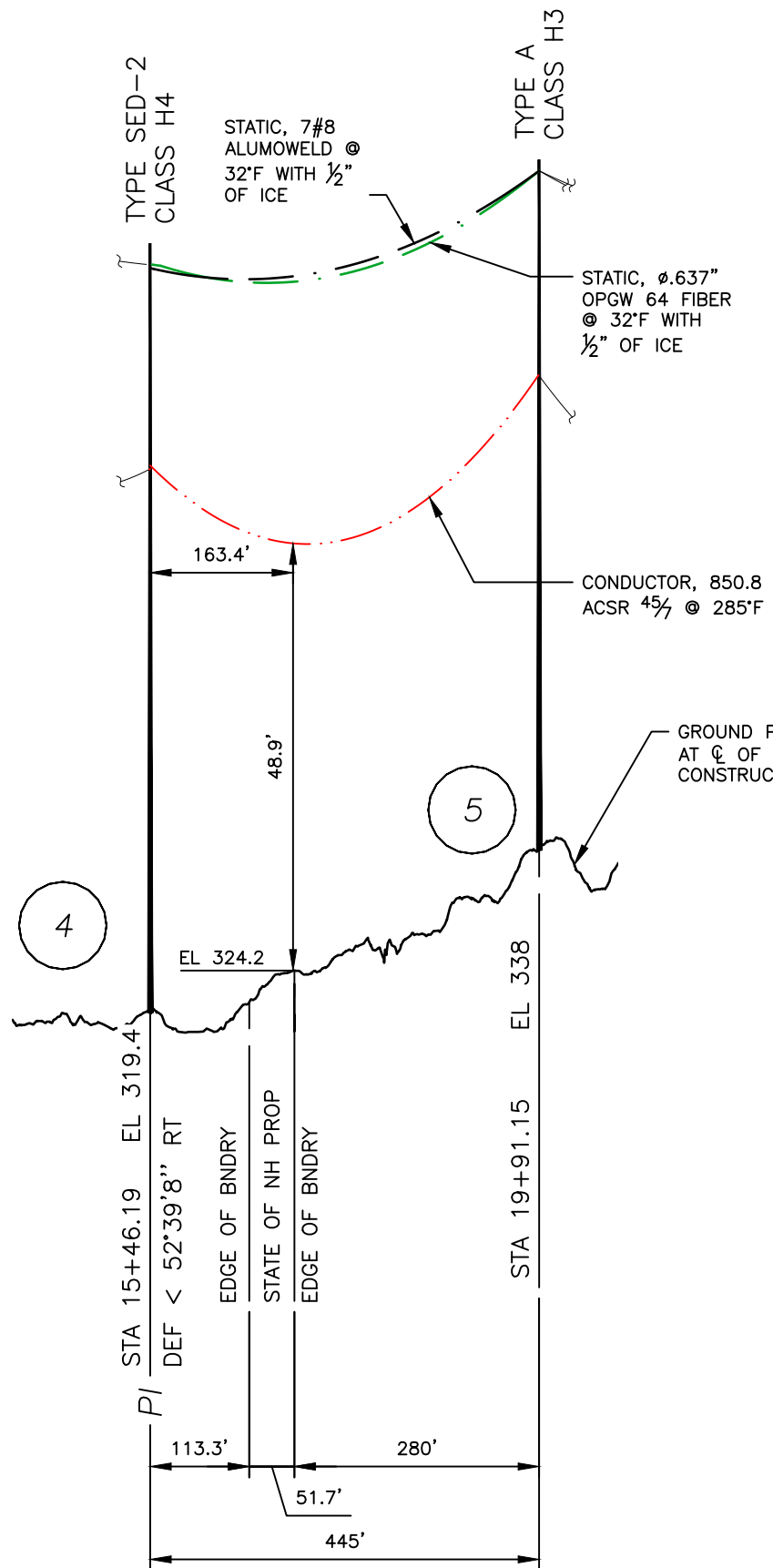

PROFILE VIEW
SCALE: HORZ 1" = 200'
VERT 1" = 20'

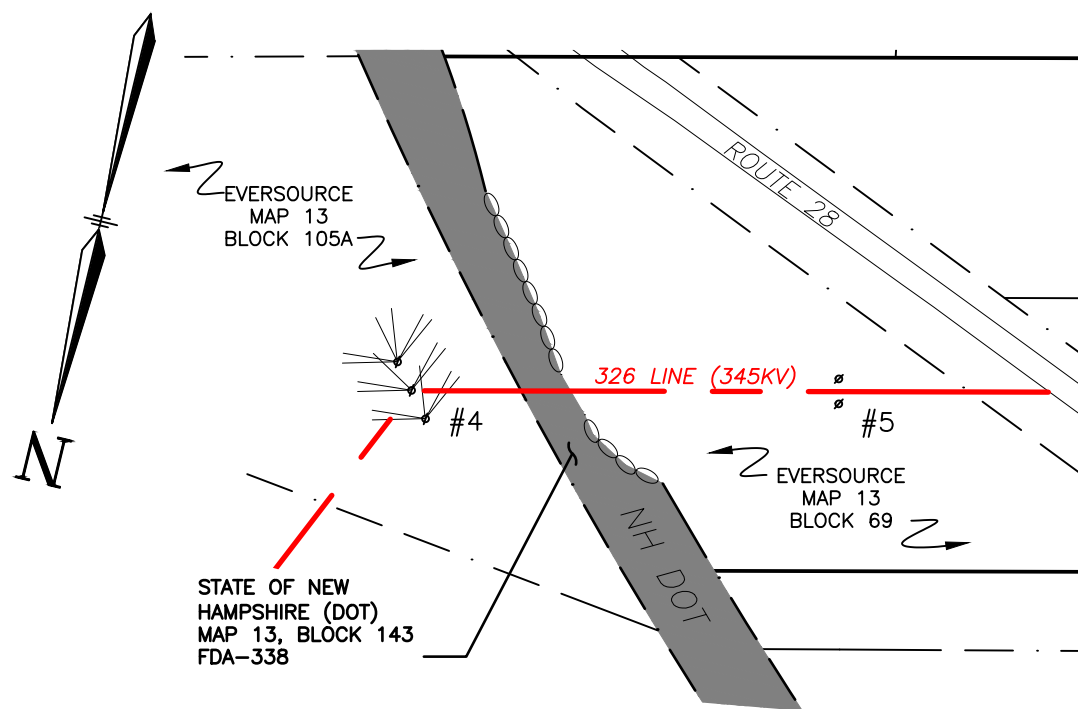

PLAN VIEW
SCALE: 1" = 200'

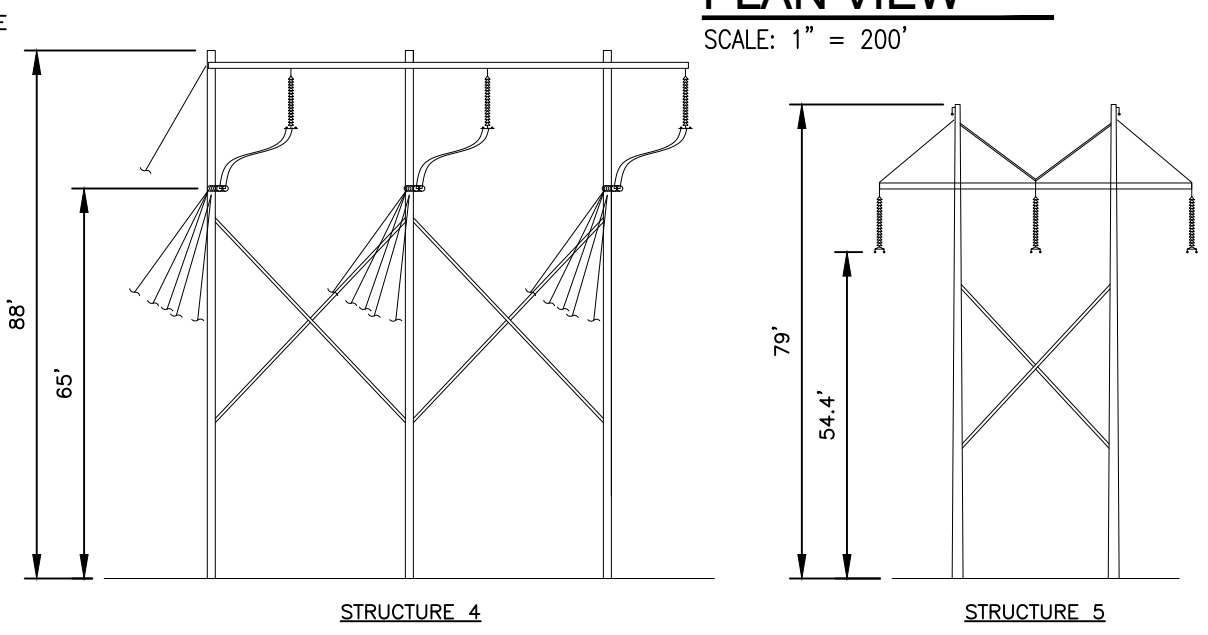

STR 4: IS A EVERSOURCE TYPE SED-2, SINGLE CIRCUIT STEEL POLE DEAD END ANGLE, HORZ. CONFIG., GUYED
STR 5: IS A EVERSOURCE TYPE A, SINGLE CIRCUIT STEEL POLE TANGENT, HORZ. CONFIG.,

STRUCTURE DETAIL
SCALE: NTS

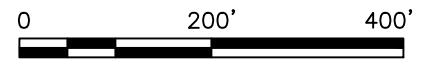

LEGEND:

- #5 STRUCTURE (WITH GUYS)
- STATE OF NEW HAMPSHIRE PROPERTY
- PROPERTY BOUNDARY
- 326 LINE 345KV LINE, C of CONSTRUCTION
- LIMITS OF EVERSOURCE RIGHT OF WAY

NOTES:

1. PARCEL INFORMATION FROM SITE SURVEY.
2. ELEVATIONS REFERENCED TO THE NORTH AMERICAN VERTICAL DATUM OF 1988.

STRUCTURE LOCATION		
STRUCTURE	LONGITUDE	LATITUDE
4	-71.34577014	42.90158718
5	-71.34738672	42.90130783

NESC VERTICAL CLEARANCE (FT) FROM TABLE 232.1	
NATURE OF SURFACE UNDERNEATH WIRES, CONDUCTORS OR CABLES	345kV
TOP OF TRACK	32.8

CABLE SCHEDULE						
WIRE	QTY OF CABLES	DESCRIPTION	DESIGN CONDITIONS			
			MAX DESIGN TENSION (lb)	TEMP (°F)	ICE (in)	WIND (psf)
CONDUCTOR	3	ACSR, 850.8 kcmil 45/7, BUZZARD	7500	0	0.5	4
STATIC	1	7#8 AW	5500	0	0.5	4
OPGW	1	64F Ø0.637" OPGW	4600	0	0.5	4

DWG REV	EPN/DESCRIPTION	CONT/PE#	DATE	DRN	CHKD	APPR
2	RESUBMITTED TO STATE PUC DRAFTING CORRECTION		03/17/21	GBS	CJN	CJN
1	SUBMITTED TO STATE PUC		03/15/21	GBS	CJN	CJN

EVERSOURCE ENERGY

326, 345kV LINE
STATE OWNED LAND CROSSING
LONDONDERRY, NEW HAMPSHIRE
EXHIBIT 2

SCALE AS SHOWN	FILE: 032643501.DWG IMAGE:	DRAWING NO. 032643501
-------------------	-------------------------------	---------------------------------